

www.telephones.att.com



User's manual Part 2

SynJ®

SynJ SB67128 DECT 6.0 Repeater

This manual contains information about this product's installation and operation. Please also read **Part 1 - Important product information**.

For customer service or product information, visit our website at **www.telephones.att.com** or call **1 (888) 915-2007**. In Canada, dial **1 (866) 288-4268**.



Before you install

Parts list

- SynJ® SB67128 DECT 6.0 repeater
- Power adapter
- Part 1 Important product information
- Part 2 User's manual
- Package of screws



Use only the power adapter supplied with this product. To obtain a replacement, visit our website at **www.telephones.att.com** or call **1 (888) 915-2007**. In Canada, dial **1 (866) 288-4268**.

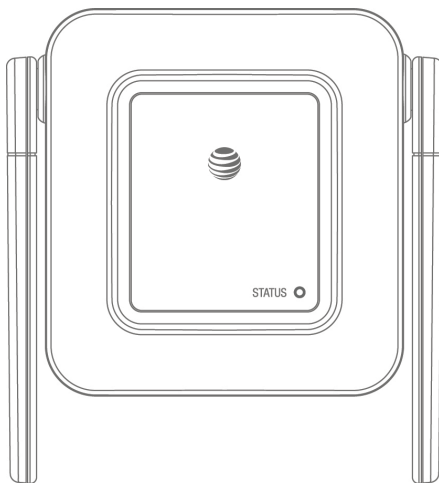

Figure 1: Repeater

About the repeater

You can use a repeater to extend the operating range for the SynJ SB67118/SB67138/SB67158 DECT 6.0 4-line corded/cordless telephone system to cover areas where the signal is very weak or not available. The repeater extends the range in all directions, even going around certain barriers.

The telephone base, cordless handsets and repeaters are linked through wireless connections. When configured properly, you should not notice any reception problems as you move around within the covered area.

Up to six repeaters can be registered to the telephone base. There can be two repeaters in series going between the base and handsets. The first repeater can be up to 980 feet away from the base. The second repeater can be up to 980 feet away from the first repeater. Handsets work up to 980 feet from the base or any repeater, so with two repeaters in series, handsets work up to 2,940 feet away from the base. The following figure shows an example of how you might choose to setup your system.

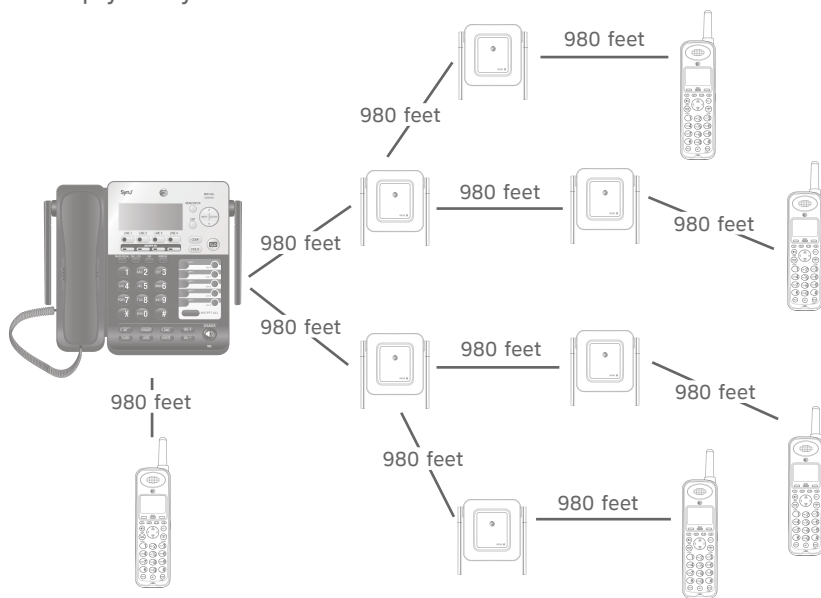

Figure 2: Planning repeater placement

Registration

You should register your repeaters to the telephone base before choosing locations for them in the building.



NOTE: You can register a repeater to a SynJ SB67118/SB67138/SB67158 telephone base without deregistering it from the previous telephone base. New registrations overwrite any previous repeater registrations.

Repeater registration

1. Plug in the repeater to AC power. The **STATUS** indicator light on the repeater flashes slowly.
2. Press and hold the **SETUP** button at the bottom of the repeater for two seconds. The **STATUS** indicator light on the repeater flashes quickly.
3. On the telephone base, press **MENU/ENTER**.
4. Scroll down to **Registration** and press **MENU/ENTER**.
5. Press **MENU/ENTER** again to select **Register HS**. The SynJ SB67118 telephone base screen shows **Handset registering** during registration. The SynJ SB67138/SB67158 telephone base screen shows **Registering new device...** during registration. It takes about 60 seconds to complete the registration.
6. The **STATUS** indicator light becomes solidly lit. The telephone base shows **Repeater registered** and beeps when registration is successful.

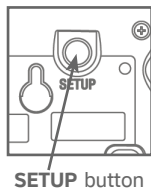
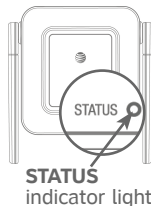

NOTES:

- If the registration is not successful (the **STATUS** indicator light is not lit after 60 seconds), the telephone base screen shows **Error**. Try the **Repeater registration** process again.
- A registered repeater does not count as an extension and does not have an assigned extension number within the telephone system.
- For complete registration instructions of a SynJ SB67118/SB67138/SB67158 telephone base, please refer to the manual provided with your SynJ SB67118/SB67138/SB67158 product, or visit **www.telephones.att.com/smb** to download the manual.

Registration

STATUS indicator light

Slow flash	The repeater is powered on and in idle mode waiting to be registered again. -OR- The registered repeater is not connected to the telephone base. -OR- Your telephone base has no power.
Quick flash	The repeater is registering to the telephone base.
On	The repeater is successfully registered and in a normal operation mode.
Off	The repeater has no power.

Installation

After you have plugged in your repeaters in the locations you think the best, place a call from a cordless handset (SynJ SB67108). While talking, move around the building to test the reception. You may want to adjust the position of repeaters to receive the best reception.

Plug the small end of the power adapter into the power jack on the front of the repeater and route the cord through the slot on the bottom of the repeater.

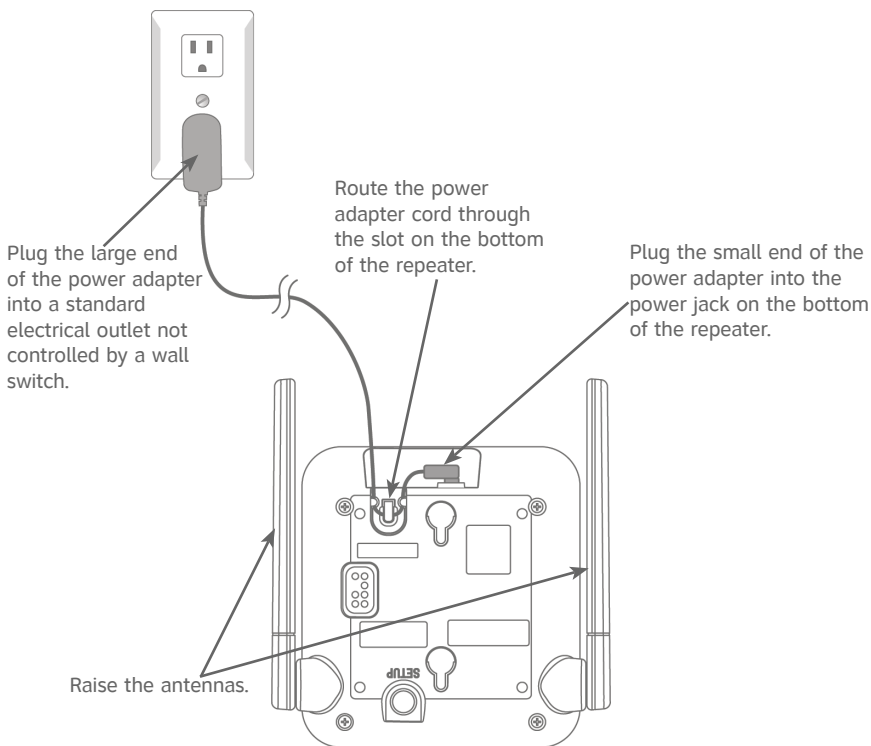

Figure 3: Connect the power adapter to the repeater

Installation

You can place the repeater on a tabletop. You can install your repeater on a wall or other object with the provided screws. Please use the recommended placement and installation tips as follows:

- The antennas need to be in a high location (not on the floor or under a desk) for reception.
- Maintain a minimum of 30 feet distance between each repeater.
- See page 2 for additional placement information.

If you place the repeater on a tabletop, plug the large end of the power adapter into a nearby electrical wall outlet and raise the antennas.

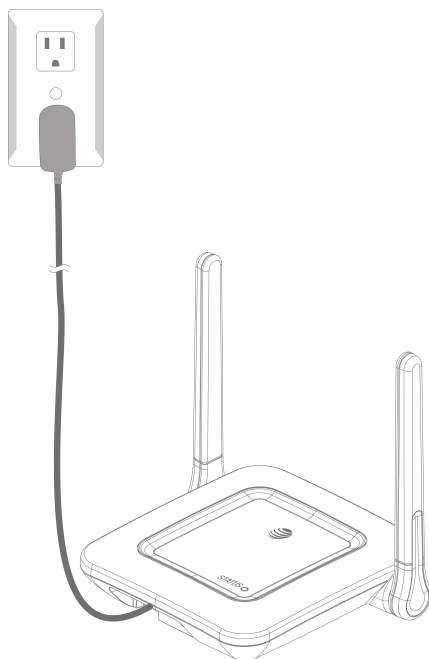

Figure 4: Tabletop installation

Installation

If you want to install your repeater on a wall or other object, use the provided screws. Professional assistance may be required to install screws on the wall. Then, plug the large end of the power adapter into a nearby electrical wall outlet and raise the antennas.

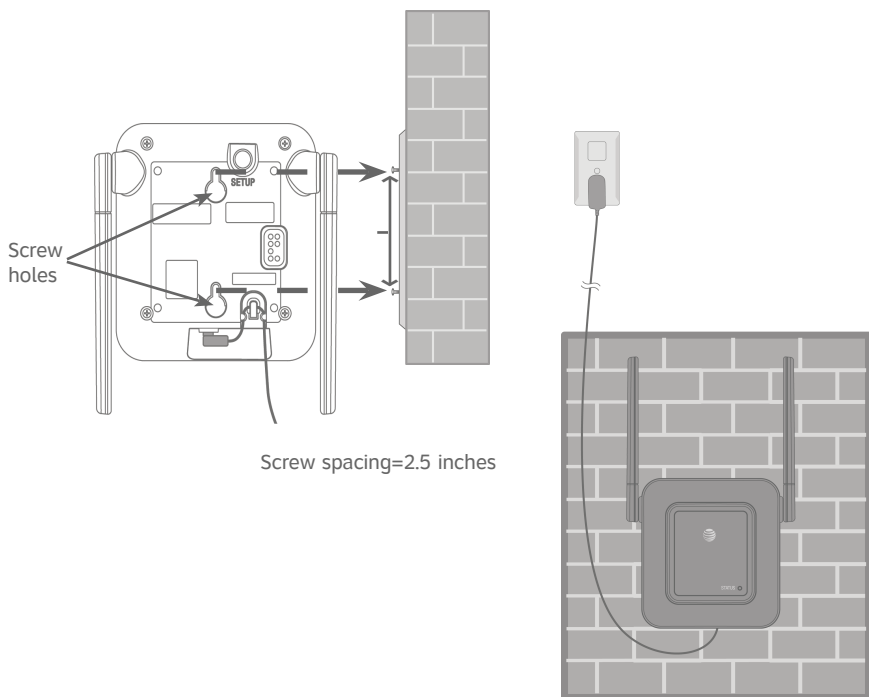

Figure 5: Wall installation



NOTE: The power adapter is intended to be correctly oriented in a vertical or floor mount position. The prongs are not designed to hold the plug in place if it is plugged into a ceiling, under-the-table or cabinet outlet.

Troubleshooting

If you have difficulty operating this repeater, try the following suggestions. To contact Customer Service, purchase accessories or obtain replacement parts, visit our website at **www.telephones.att.com** or call **1 (888) 915-2007**. In Canada, dial **1 (866) 288-4268**. Please retain your receipt as your proof of purchase.

My repeater doesn't work at all.

- Make sure the power cord is securely plugged in.
- Make sure the **STATUS** indicator light is on. If the light is off or flashing, the repeater is not registered or the base has no power.
- Make sure you raise the antennas of your repeater.
- Make sure you install the repeater in a high location (not on the floor or under a desk) for better reception.
- Do not place the repeater near a microwave oven or on the same electrical outlet. You might experience decreased performance while the microwave oven is operating.
- Other electronic products such as HAM radios and other DECT phones, can cause interference with your repeater. Try installing your repeater as far away as possible from these types of electronic devices.
- You may need to walk to the location of your repeater and initiate a call from your cordless handset (SynJ SB67108) to test if the reception of the cordless handset is good. If the performance is less than expected, you may need to relocate your repeater closer to the telephone base. Then, try placing a call on the cordless handset again.

Troubleshooting

My repeater cannot register to my telephone base.

- First try all the suggestions on the previous page.
- Make sure your telephone base is a SynJ SB67118/SB67138/SB67158 DECT 6.0 4-line corded/cordless telephone system.
- Carefully follow the registration instructions on page 3 of this user's manual.
- Make sure your telephone base is within 980 feet of the repeater. If registration does not work, place the repeater next to the base and try registering again.

My repeater flashes slowly again after registration.

- First try all the suggestions on the previous page.
- Make sure the telephone base has power.

I cannot deregister my repeater from the previous telephone base.

- You can register a repeater to a SynJ SB67118/SB67138/SB67158 telephone base without deregistering it from the previous telephone base. New registrations overwrite any previous repeater registrations.

Power failure recovery.

- Your registered repeater automatically links to the telephone base wherever power is restored. The **STATUS** indicator light is on when there is a valid link.

General product care

To keep the repeater working and looking good, follow these guidelines:

- Avoid putting it near appliances and devices that generate electrical noise (motors, fluorescent lights, etc.)
- **DO NOT** expose it to direct sunlight or moisture.
- Avoid dropping the repeater.
- Clean with a soft cloth.
- Never use a strong cleaning agent or abrasive powder because this will damage the finish.
- Retain the original packaging in case it is necessary to ship it at a later date.

Technical specifications

RF frequency band	1921.536MHz - 1928.448MHz
Channels	5
Operating temperature	32°F - 122°F 0°C - 50°C
Repeater voltage (AC voltage, 60Hz)	110Vrms - 120Vrms
Repeater voltage (AC adapter output)	6VDC @600mA

SynJ SB67128 repeater disclaimer range 980 feet

Open range test was performed by Wyle Laboratories, an independent commercial test facility. “Up to 980 feet” repeater range refers to the maximum open field range. Actual range may vary depending on intervening obstacles.

Repeater operating range

This repeater operates within the maximum power allowed by the Federal Communications Commission (FCC). Even so, this product can communicate over a certain distance — which can vary with the locations of the telephone base, the weather, and the construction of your building.